



WELCOME TO

CASTLE VIEW ACADEMY



Castle View Academy
The best in everyone™
Part of United Learning

Welcome to CVA!

Welcome to Castle View Academy! This booklet will give you some more information about your new school.

Section	Page
CVA Values	2
Uniform	3
PE Kit	4
School Building	5
School Day	7
Equipment	8
Behaviour	9
Homework	9
Canteen	10
Clubs & Activities	11
Support	12
Notes	13

CVA Values

We have high standards for everyone at Castle View Academy.
We expect a positive attitude and good standards of presentation at all times.

Our three core values are:

#Ambition #Determination #Respect

We expect that you will demonstrate these values at all times as we believe these values are important to both you and your community.



What does ambition mean?

What does determination mean?

What does respect mean?

How can you show ambition in your new school?

How can you show determination in your new school?

How can you show respect in your new school?

Uniform

At Castle View Academy we expect you to look smart and wear the correct uniform from day one.

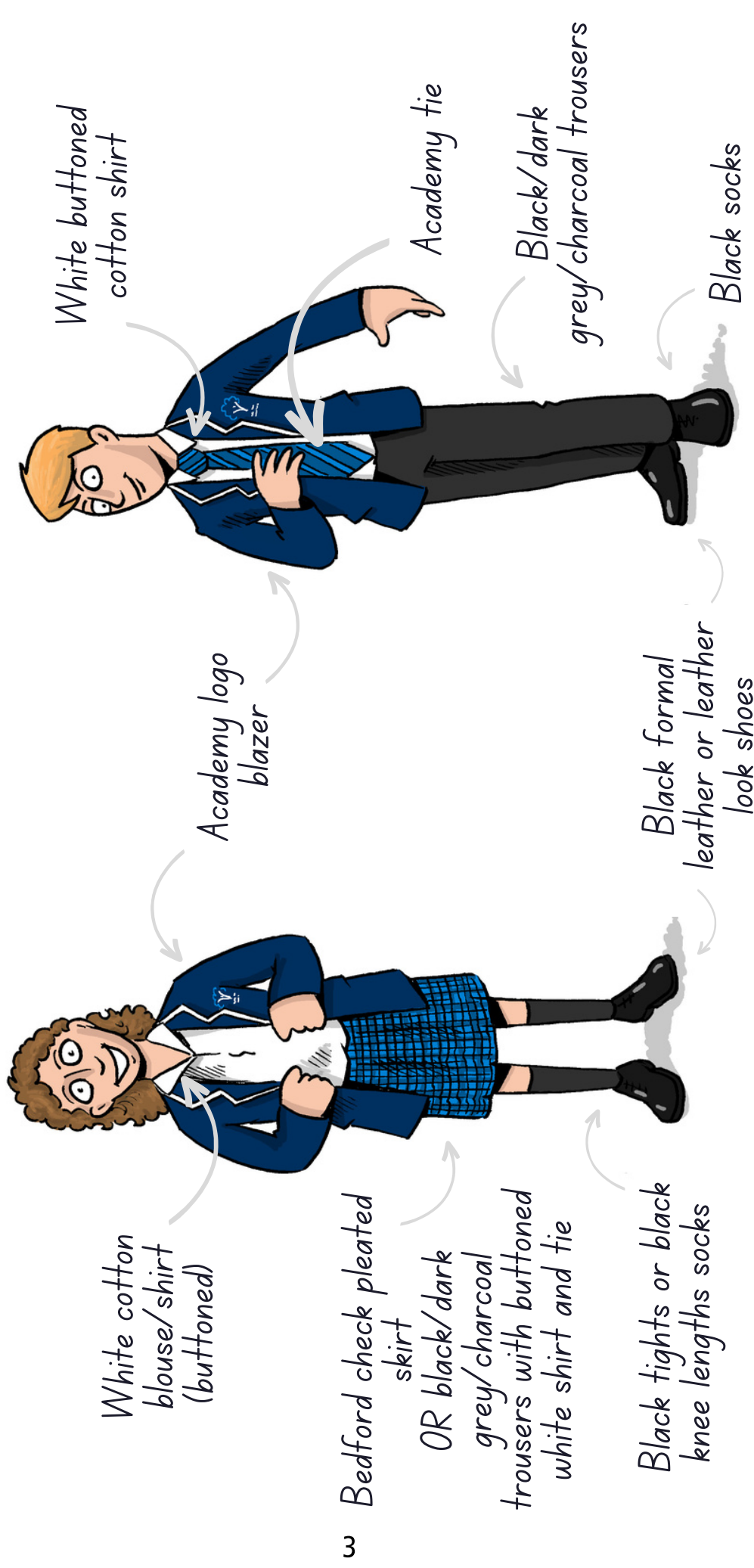

Optional: Academy logo jumper

PE Kit

Uniform includes wearing the correct PE kit which must be brought into school on the days you have PE/Dance.

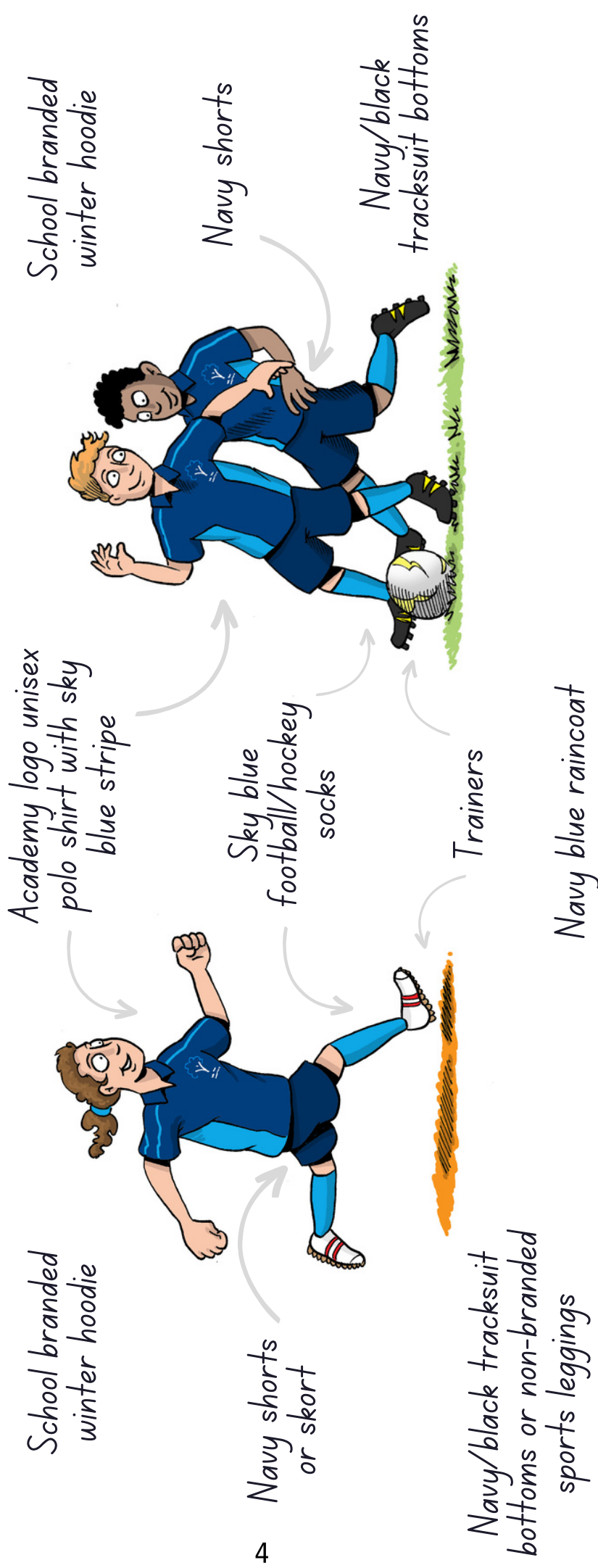

Students will also take part in dance lessons.

School Building

The school building has 4 floors. Each area of the building has a different department.

Lower Ground Floor

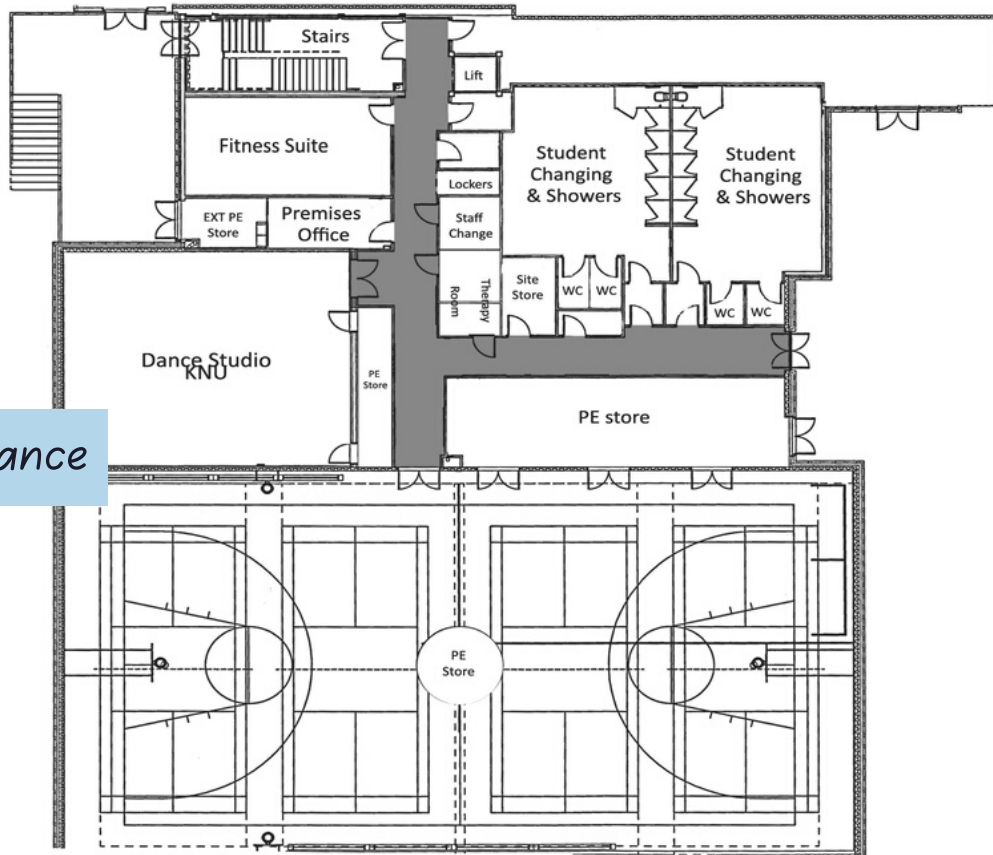

Ground Floor

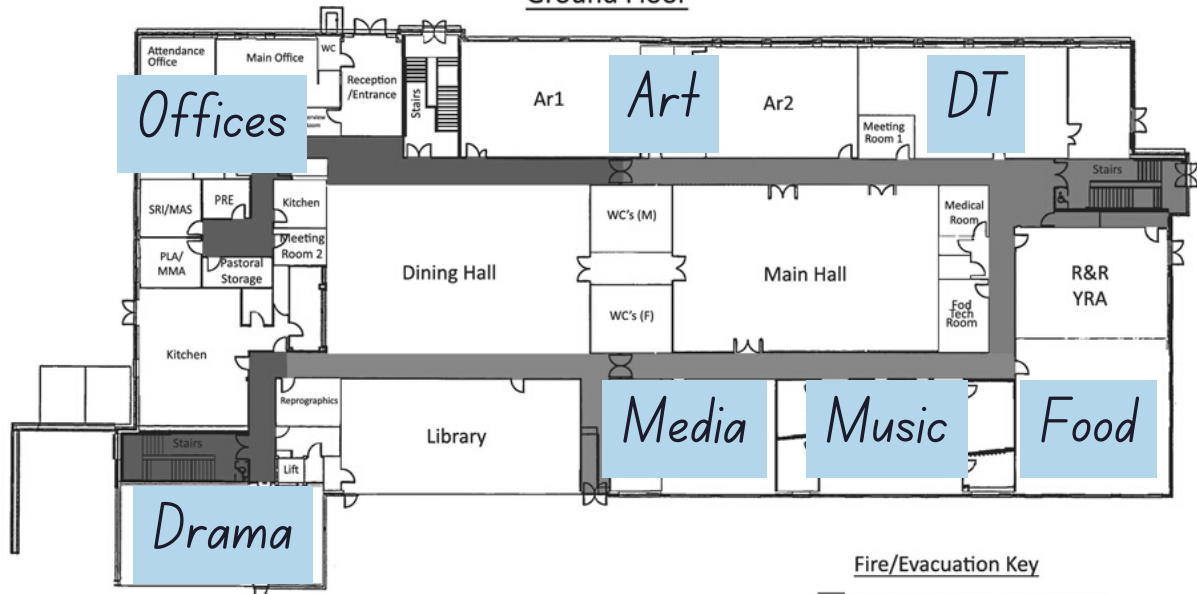

Fire/Evacuation Key

- Assembly Point A - Tennis Court
- Assembly Point A - Tennis Court
- Assembly Point A - Tennis Court

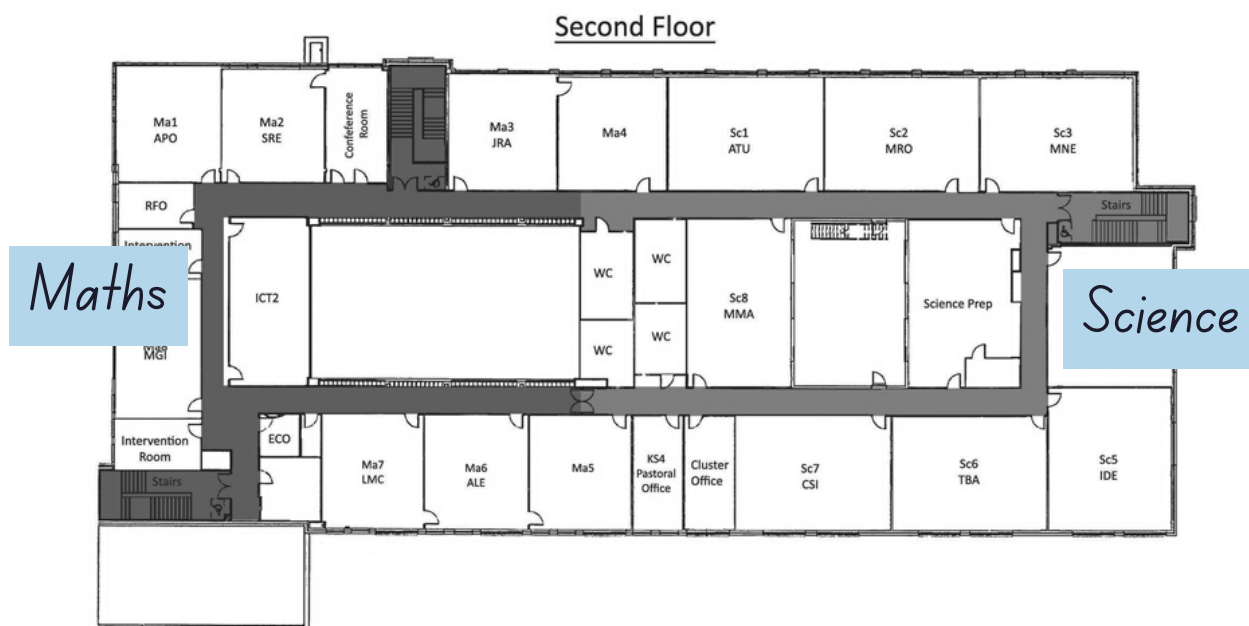
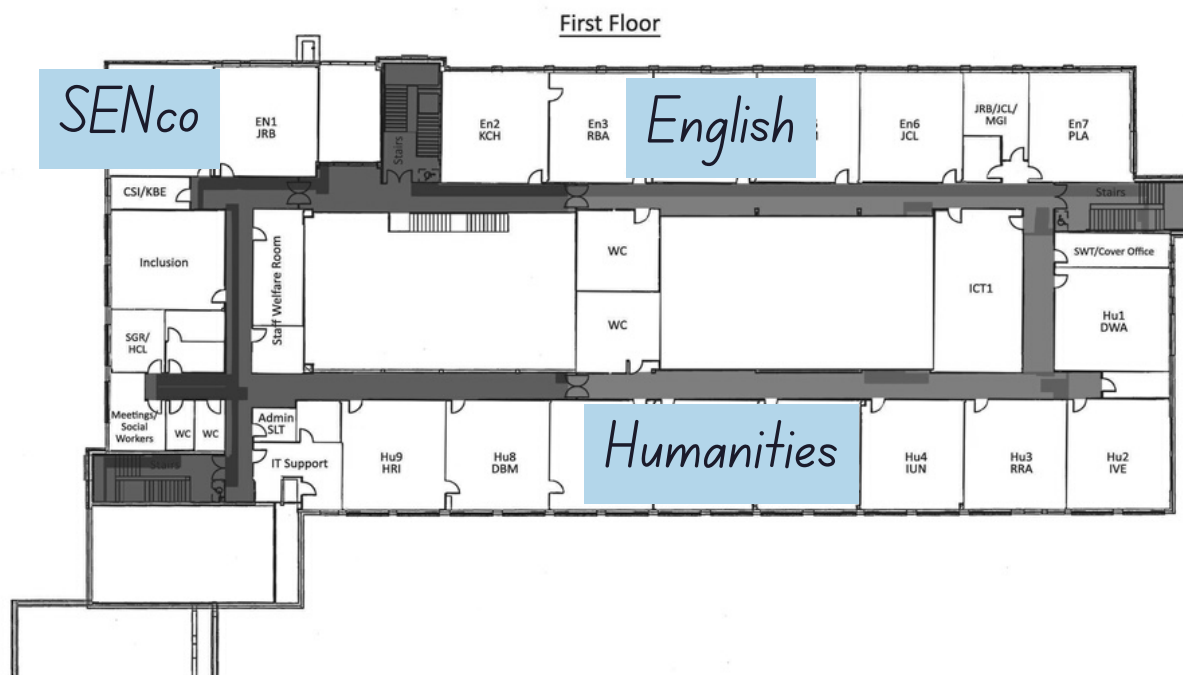

Only one set of stairs leads to the lower ground floor, can you find it?

School Day

At CVA we all follow the same timings each day. This can be seen on the right.

What is roll call?

Roll call is an opportunity for your tutor to check that you are prepared for the day's learning.

Break and Lunch Time

During break and lunch you will be able to spend time with your friends outside or inside. You will also be able to buy food from the school canteen.



What is tutor time?

Before lessons begin, you will have tutor time. Your tutor is there to help you be ready for the day and will check your equipment. During tutor time you will have different activities like reading, assembly and personal development sessions. These sessions will be run by your tutor.

Lessons

Each day you will have different lessons. For each lesson you will move classrooms. Our timetable is made up of 2 weeks (Week A and Week B). You will be given a timetable which will tell you what lesson you have and where it is.



Roll Call	8:30 - 8:35
Tutor Time	8:35 - 9:10
Period 1	9:10 - 10:10
Period 2	10:10 - 11:10
Break	11:05 - Year 7/8/9 11:10 - Year 10/11 Until 11:30
Roll Call	11:30 - 11:35
Period 3	11:35 - 12:35
Period 4	12:35 - 13:35
Lunch	13:30 Year 10/11 13:35 Year 7/8/9 Until 14:05
Roll Call	14:05 - 14:10
Period 5	14:10 - 15:10
Roll Call	15:10 - 15:15

Equipment

You will need to bring the correct equipment with you in a sturdy school bag.
Below is the equipment you will need to bring to school **everyday**.



During tutor time, your tutor will check you have the correct equipment by using the equipment mat:

Equipment Mat				
CV Card	Large clear plastic pencil case			
	Scientific Calculator			
30cm clear plastic ruler				
KS3 Do you have your homework booklet?	Protractor	Black Pen x 2		Highlighter
		Green Pen x 2		
Do you have all your equipment?	Eraser	Sharpener	Pencil x 2	



Castle View Academy
 The best in everyone™
Part of Colston Learning

Behaviour

We believe in rewards rather than sanctions, but sometimes poor behaviour will result in consequences.

All students will have a "CV card" that gets marked when a student does something that does not meet our expectations e.g., not wearing the correct uniform. If you get too many marks on your card, unfortunately, there will be a sanction.



YEAR 7 #CV PROUD			
Name	Card No.		
Tutor			
	1st	2nd	3rd
Incorrect Uniform			
Swearing			
Lack of equipment			
Not following staff instructions			
Poor corridor/break time behaviour			
Poor assembly/ lesson/ roll call line up behaviour			
Chewing gum			
Late to lesson			

If you reach the end the week without any marks on your CV card, you will receive "Epraise" points. Epraise is a way of recording points for good behaviour and efforts. Points can be traded for treats, vouchers and lots more.



Homework

Each week you will be expected to complete homework in your homework booklet for different subjects. We expect homework to be completed to the highest standard you can achieve.

If you are struggling to complete your homework, you can talk to your subject teacher or go to homework club (run by the SEN team) for extra support.



Canteen

We operate a cashless canteen system which means we don't accept cash for food purchases. Your account can be topped up at the machine in school or at home on the internet. You will be given a pin code on your first day which is what you will use to buy your food. Alternatively you can bring your own food to eat at break and lunchtime.

Clubs and Activities

Clubs are a great way of getting to know people and making new friends. We recommend that you jump in and try something new. We have many clubs and actives you can join. Some of them include:

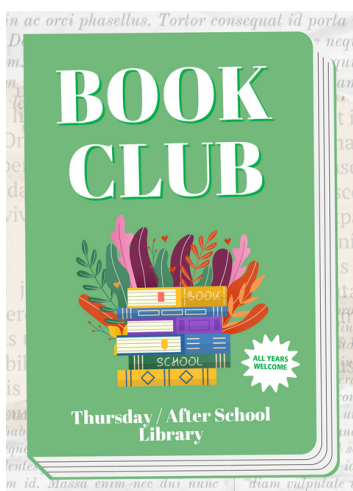
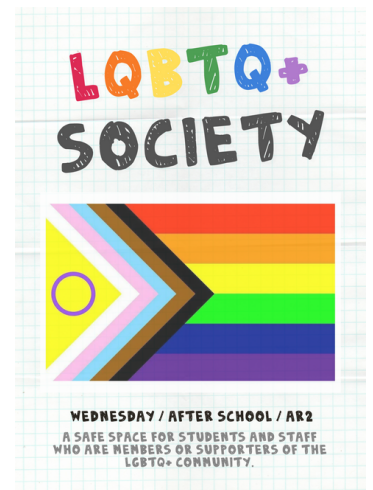
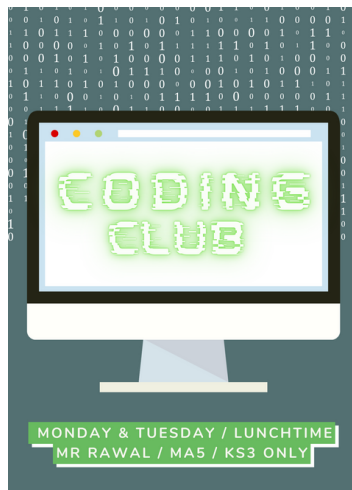

What club would you like to join at Castle View Academy?

Support

If you are worried about anything (in school or outside), you can speak to:

Year Group Support



Mr Lambert
Director of KS3



Ms Maxwell
Deputy Director of KS3



Mr Eldred
Deputy Director of KS4



Miss Richardson
Senior Year Leader
Y7 and Y8



Mrs Redman
Year Leader
Y9



Mr Aston
Year Leader
Y10



Miss Pruett
Year Leader
Y11

Student Services



Mrs Griffiths
Safeguarding
Lead



Mr Fewings
Attendance
Officer



Mrs Levers
Medical



Mrs Clark
Inclusion



Mr Beck
SEMH Lead



Ms Orchard
Pathways

You can talk to any member of staff:

Teachers, Student Services, Leadership Team, Office Staff

Notes



A large, light blue rectangular area containing numerous horizontal lines, intended for writing notes.

Notes



A large, light blue rectangular area containing horizontal lines for writing notes.